

TRACE
Soft stone tiles to capture the human traffic; A relic for the future

LEVELLING STONE
The new origin of the city; she cannot be moved

RECESS
A place to exchange; collect and deposit

ROUTES
Retain the existing paths; do not disturb.

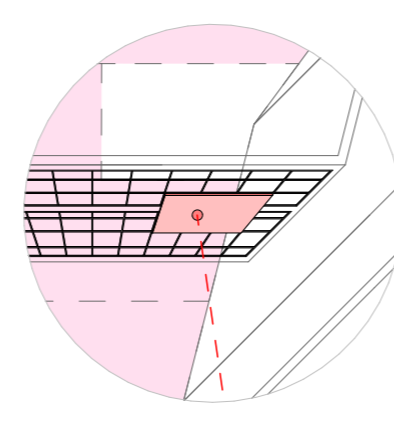
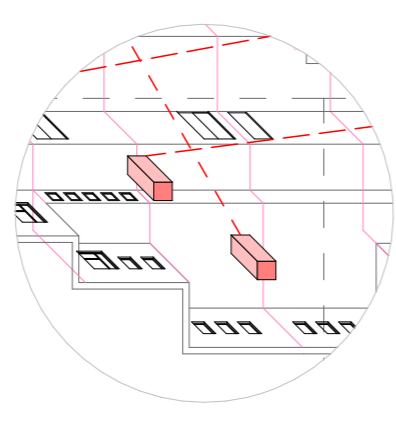
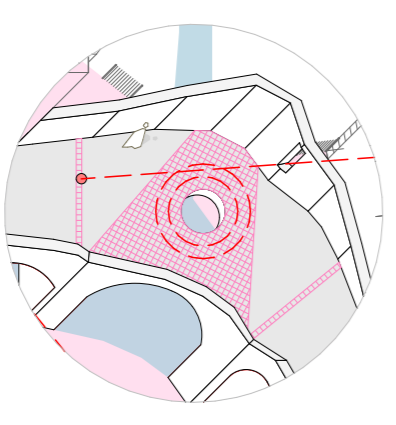
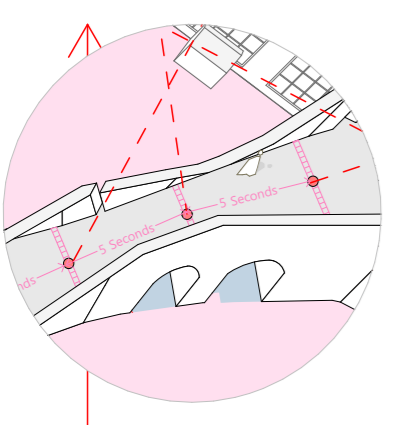

MOMENTS
Something to see every 5 seconds; something to make you stop and pause.

LEVELLING STONE
A view down to the new origin of the city

SCULPTURE DISPLAY
The lost and forgotten sculptures for all to see

ART WORK RE-HUNG
Utilising disused facades as an art gallery for the neglected and at risk

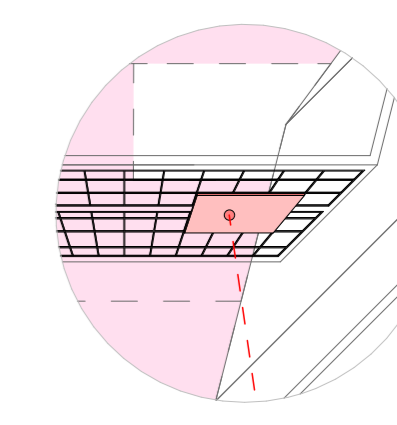
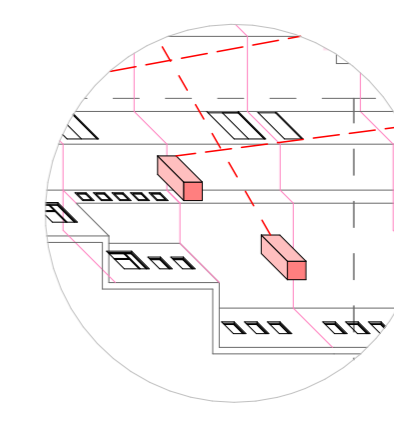
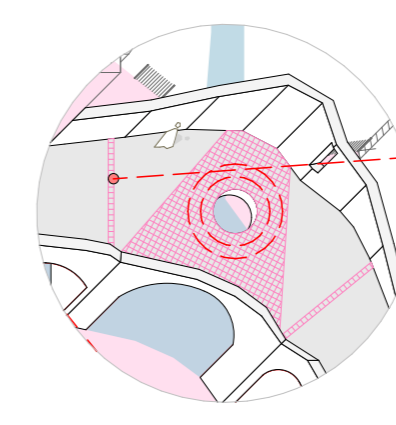
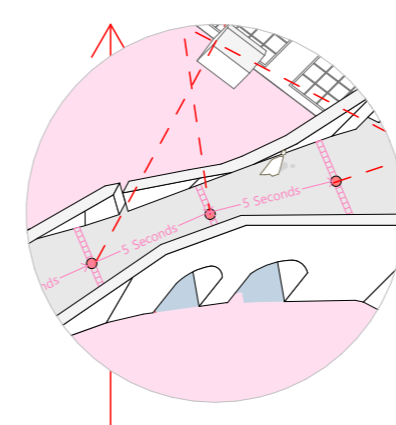

MOMENTS
Something to see every 5 seconds; something to make you stop and pause.

LEVELLING STONE
A view down to the new origin of the city

SCULPTURE DISPLAY
The lost and forgotten sculptures for all to see

ART WORK RE-HUNG
Utilising disused facades as an art gallery for the neglected and at risk